



Maverick Consulting

Engineering and Management Consulting Company

At Maverick, we have access to experienced team of experts who provide consultancy services for the benefit of the organization. The services are cost effective, time oriented based on performance that will satisfy the client. We actively assist in preparation of documentation to achieve ISO 9001 certification as well as train auditors.

Amenity Center, 8th Floor, Office No. 8/E,
Tower 1, Al Jazeera, RAK – UAE,
Mobile: - +971-50-4902306, +971-55-6815017
Email: - rahul@maverick-consulting-fzllc.com
uk@maverick-consulting-fzllc.com
Web: - www.maverick-consulting-fzllc.com

5576 Magowe Road
Kalundu, Lusaka, Zambia
P.O.Box NM31, Lusaka, Zambia
Ph No. +260-973-393-965
Email: - info.maverickconsulting@gmail.com

OUR LEADERS



U K SenGupta

With over 45 years of experience, “UK” is a Cement Technologist who has worked in many countries in Africa, Middle East and South East Asia as Plant Manager and General Manager. As technical consultant he has been involved to set up, erection and commissioning/JV new plant capacity enhancement projects, energy audit and many others.



Rahul Kanjilal

Rahul has over 20 years’ experience in finance and business management. He has had opportunity to work in different financial and economic environments in Africa and Asia. He has served as CEO of a prominent company in Zambia and Director of several companies. Rahul is a Chartered Accountant with a Bachelors of Commerce.



Debasis Bera

Debasis has more than 30 years of rich experience in cement industry and design application. Worked as Senior consultant – PEG-SA, Geneva 1 year, technical director – (APAC)-ATEC, Austria 10 years, General Manager (Process Engg) ENEXCO 3 years, Saurashtra cement – Process Engg in charge 4.5 years, earliest stint at Andhra cement – 13 years.

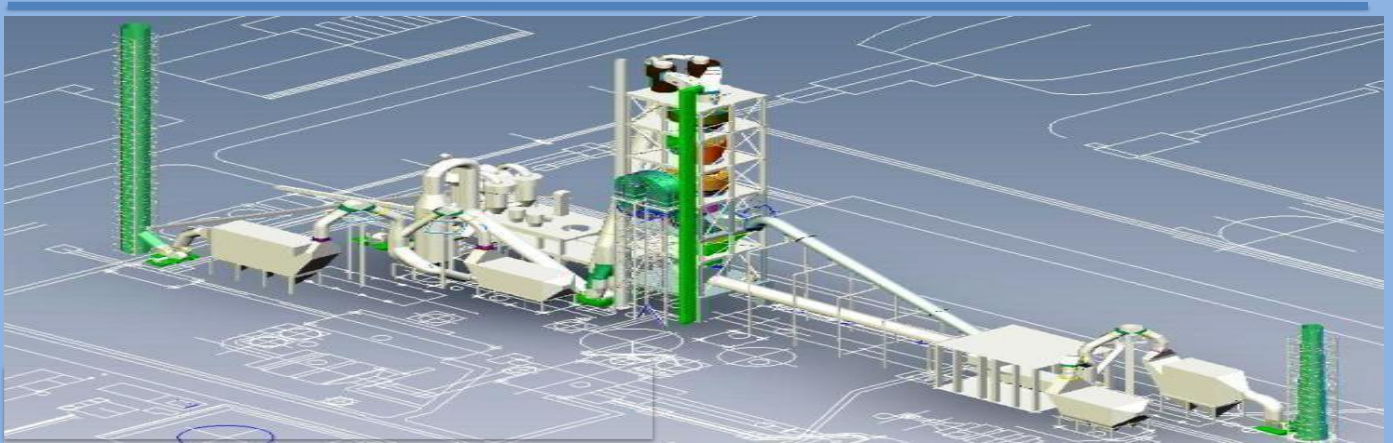

Simplify Business

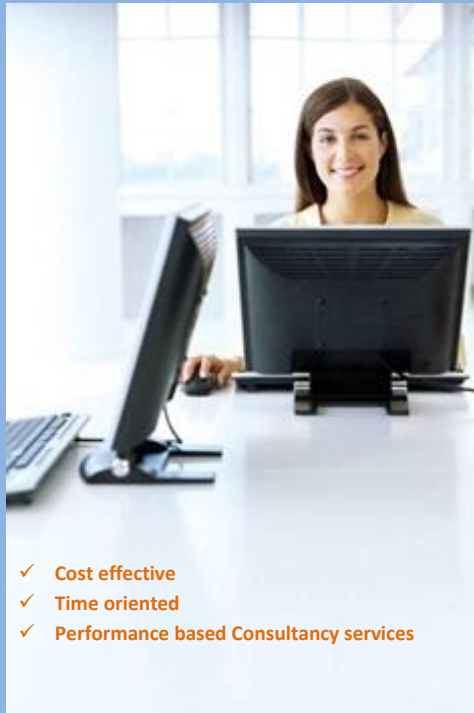

- ✓ Cost effective
- ✓ Time oriented
- ✓ Performance based Consultancy services

Our Scope

- ✓ Management Audit
- ✓ Plant Audit
- ✓ Energy Audit
- ✓ Trouble shooting
- ✓ Cost control
- ✓ Inventory Control
- ✓ ISO9001 Documentation preparation for certification
- ✓ Internal ISO9001 Auditors training
- ✓ Continuous Productivity and Quality improvement of the plant
- ✓ Plant maintenance check list preparation (mechanical, electrical & production)
- ✓ Mining plan can be prepared
- ✓ Proper Raw mix design can be checked and ensured
- ✓ Plant equipment capacity can be checked and suitable action plan can be drawn for optimum utilization
- ✓ Proper manpower estimation can be determined and planning can be done to optimized the same
- ✓ Vendor optimization can be done.
- ✓ Purchasing of plant spare parts can be done cost effective manner
- ✓ Proper MIS Report for the plant can be made.
- ✓ CMMS can be prepared.
- ✓ Refractory management.
- ✓ Training can be provided to operational, quality control & maintenance staff
- ✓ Assisting plant personal to purchase plant spare parts cost effective manner without compromising the quality and time scheduled manner.

STAFFING SOLUTIONS FOR YOUR BUSINESS



“Place your best people on your best opportunities.”

We assess your staff members on their potential and reorganize them in functions suited for their best abilities. Then we recruit personnel to fill in the gaps to complete the organization's strength

SPECIALIZED TEAM TO ASSIST IN ACQUISITIONS

Whether it's a manufacturing plant that you are interested to buy or an existing business that you are merging with or you are looking to improve your current businesses, we provide the right team to assist your requirement

PROJECT MANAGEMENT AND MONITORING SERVICES

We carry out Project Management & Monitoring Services, which includes drawing up department wise bar charts of various activities and sub-activities using the MS. Project Software. After the orders for major equipment have been finalized, a plan of detailed activities and their duration in consultation with Client and the turnkey machine supplier is prepared.

BASIC AND DETAILED ENGINEERING

We are fully equipped expertise & infrastructure for undertaking complete basic engineering, vendor procurement assistance & detail engineering for Process, Mechanical, Electrical, Instrumentation & Automation, etc.

Basic Engineering & Procurement Assistance – It comprises of

- Finalization and preparation of plant layout.
- Finalization and preparation of detailed flow sheet.
- Preparation of board machinery technical specifications for all the plant and auxiliaries including Electrical & Instrumentation.
- Technical evaluation of offers received from suppliers and provides purchase recommendation.
- Assist in finalizing the agreement including guarantee clauses etc with the main plant & machinery supplier.

Detail Engineering – It Comprises of

- Mechanical - covering review of all drawings submitted by the vendors, preparation of fabrication drawings for all ducts, chutes, interconnecting devices, platforms, ladders, staircases etc., including checking compatibility of all mechanical drawings with civil, Electrical and Instrumentation drawings.
- Electrical & Instrumentation - covering review & checking of all drawing received from vendors, finalization of Electrical system layout for entire plant including PCC/MCC rooms, CCR etc., Cable Schedule & routing, PI diagrams, Earthing and Protection system, communication system, plant lighting etc

ENVIRONMENT STUDIES (EIA / EMP)

We can carry out comprehensive Environmental Impact Assessment (EIA) study and developed Environmental Management Plan (EMP).

The scope of coverage under EIA / EMP studies includes:

- Ambient air quality (SPM, SO₂, NO_x & CO).
- Metrological Data (Wind Velocity & Direction, Temperature, Humidity, Rainfall etc.)
- Water environment including water bodies & water quality.
- Noise environment including noise levels & ground vibration studies.
- Land environment including soil analysis & any existing solid waste disposal.
- Environment covering aquatic life habitats like mangroves, wetland.
- Economic Environment data on people, land use pattern, historical monuments etc., industries within 10 KM radius.

GEOLOGY AND MINING

We have dedicated team of highly experienced Geologist, Raw Materials technologist & Mining Engineers to carry out investigation and assessment of the client report of covering complete geological prospecting documents including topographic survey, core drilling, geological mapping, sample and its analysis report

Flexible solutions for your business needs ERP IMPLEMENTATION

A common mistake in implementing an ERP is handling the exercise over to the software implementer without conducting a thorough business review process.

This invariably leads to extensive time and cost over runs of the implementation process.

At maverick consulting we first asses the ERP suitability for the clients by first conducting a business process review which provides a clear picture of the requirements or challenges being faced, thereafter we become the liaison working hand in hand with the ERP implementer and the client's staff members.

BUSINESS PROCESS REVIEW

Our team of experts conducts a thorough review of your business process which is converted in to detail flow charts. These are then analyzed to identify and eliminate duplicate or more repetitions of the same activity thereby improving of the overall productivity of the company without compromising on risks of the business environment in which the company operates and achieve overall cost control.

BUSINESS SOLUTION

We deploy a cross section of experts from different fields, whose combined experience pool suggests solutions to deal with the specific challenges that a client may be facing.



OPERATION AND MAINTENANCE OF THE PLANT

Operation & maintenance of the plant by deputing experienced mechanical, E & I, process and quality control persons.

TECHNICAL AUDIT

We can do technical audit for Mining, Crushing, Drying, Grinding, Pyro-process, Fuel preparation, Packing & Dispatching section

INNOVATIVE SOLUTION IN SEPARATION TECHNOLOGY

For separator - Special design of static and dynamic blade

- ✓ Secondary classification in return cone to recoup the maximum particle

Parameters	Existing	With SCRC
Efficiency@-45 μ	62 %	70 %
Mill power kwh/hr	22.54	21.98
Production rate tph	75.0	76.92
Blaine	3600	3600
Cement type	PPC	PPC
-45 μ in return	24.60 %	21.0 %

INNOVATIVE SOLUTION IN POWDER COOLING

For cement horizontal cooler was designed which gives –

- ✓ Higher thermal efficiency
- ✓ Higher electrical power efficiency
- ✓ Easy maintenance and operation

Many more like Pendulum flap valve with more than 91 % sealing; better kiln inlet seal; taper shim; all types of quality and reliable spare parts supply.

INNOVATIVE SOLUTION FOR PYRO-PROCESS AND VENTING SYSTEM

1. Special design features of cyclones offers maximum separation efficiency
2. Preheater is redesigned on same footing and existing cyclone cone is utilized
3. Redesign of calcinator thereby to fire all kinds of fuel
4. Energy saving with improved design of guide vane
5. Customized solution for pressure drop
6. By using Ultra LP cyclone – easy to retrofit with low investment and increase production
7. By using double dip tube cyclone – 50 % lesser diameter for same volume with lower pressure drop, lower civil and structural cost, maximum separation and requirement of lower refractory lining material

